



South Beds Golf Club

*Welcome
to Bedfordshire's
"Hidden Gem"*





South Beds Golf Club

Welcome to South Beds

South Beds Golf Club is a two-course, private members club located on the chalk, downland hills from which its courses take their names, the Galley and Warden Hills. The Club is located to the east of the A6 on the northern outskirts of Luton and is easily accessible from both Junction 10 and 11 of the M1.

Whilst South Beds has traditional roots, it is without doubt one of the most welcoming clubs in the region and is located in a rural setting that belies its close proximity to the residential areas of north Luton. With a recently up-dated clubhouse and arguably the best kept course in Bedfordshire and surrounding counties, South Beds offers members and visitors an enjoyable and challenging golfing experience.

Due to the under-lying chalk, both courses are quick drying and offer golfers excellent conditions all year round and therefore, it is no wonder that South Beds is a popular society venue, even in the winter.

History

Founded in 1892, the Club's first President, Lord Battersea, was elected in 1894 having been the Member of Parliament for the South Beds Constituency in 1892. As with most clubs of its age, South Beds evolved to embrace competition golf. Harry Vardon and James Braid, playing the course in 1904 and Harry held the course record for many years.

The subsequent decades saw two World Wars, new clubhouses and a new layout on land that was now owned by the Crown. The Club recently negotiated a new, long-term lease with the Crown for the courses to secure its heritage for many years to come.



● *Harry Vardon six times Open Champion*



Clubhouse

Opened in 1976, the clubhouse has undergone continual development during subsequent years with several extensions and most recently, a major refurbishment of both the Men's and Ladies' Locker Rooms. The clubhouse offers Members and visitors a full range of facilities, including a well-stocked bar, extensive daily catering and a Snooker Room with two full-size tables.

In addition to a busy social programme for Members, the Club is available for private functions with a range of dining options.



Professional's Shop

South Beds retains the services of PGA Professional Michael Davis and whether you need new clubs, a repair or a lesson, he is on hand to assist you. A full range of clothing for both sexes, is available seven days a week from our well stocked shop. Contact Michael on 01582 591209 for further information.

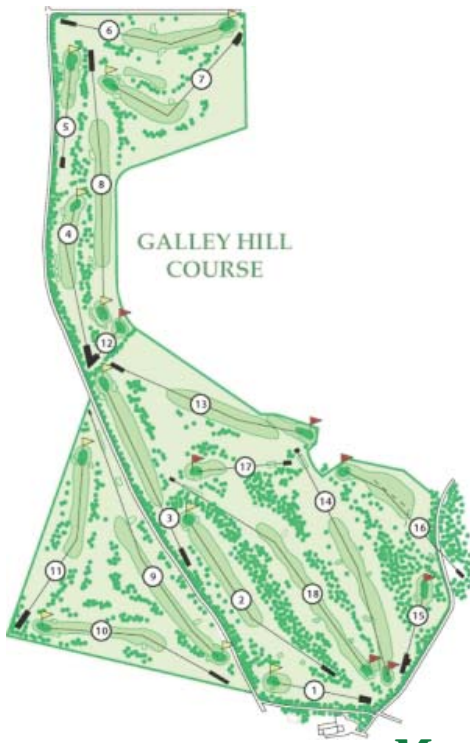

Galley Hill Course

6401 yards in length, with a Par and SSS of 71, the Galley Hill Course is recognised as one of the best in Bedfordshire. Harry Vardon described South Beds G.C. as "Bedfordshire's hidden gem".

Warden Hill Course

The 9-hole Warden Hill Course presents a challenge for golfers of all standards. 4794 yards long for 18 holes with a Par of 64, a popular choice for visitors and Club Members alike, this course enables the Club to offer affordable golf to local golfers, many of whom go on to become Members of South Beds.

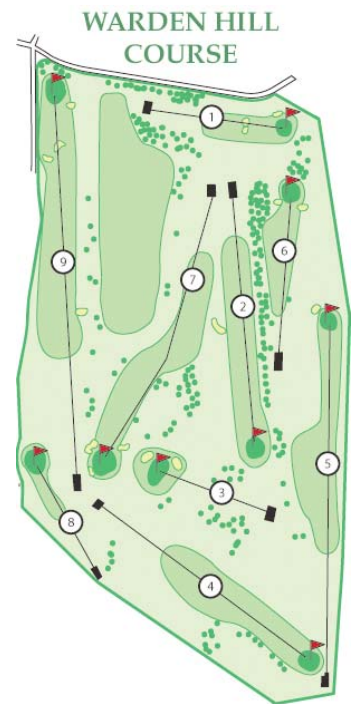

Membership

As a registered Community Amateur Sports Club, South Beds G.C. has an open admissions policy and applications are welcome for all categories of membership.

Membership Payment Methods

We have many packages available to new members making it affordable for you to join this forward thinking club.

We accept Cash/Cheque/Cards or alternatively our monthly payment scheme which allows you to spread the cost over 10 months, making membership very affordable (a small charge is incurred when using this method) please contact our Secretary/Manager, Ray Wright, on 01582 591500 for further details.

Membership Category	Annual Subscription	Joining Fee
Full Member <i>Unlimited Golf</i>	£821 <i>£15.79/week</i>	£375 or £75 a year for 5 Years
5 Day Member <i>Mon-Fri</i>	£662 <i>£12.73/week</i>	£200 or £40 a year for 5 Years
Social Member	£65	Nil

Discounts available for those joining part-way through the year (25% from 1st April, 50% from 1st July & 75% from 1st October)



**BECOME A MEMBER
FOR AS LITTLE AS £75 PER MONTH**

Golf Society & Corporate Day Packages

Visiting groups are most welcome at South Beds with packages available for groups of 12 or more on Mondays, Wednesdays and Thursday's on the Galley Hill Course (18 holes) and everyday on the Warden Hill Course (9/18 holes).

Package 1

*Coffee and Bacon Roll
on arrival*

18 Holes

*Soup & Ploughman's
Lunch*

£35.00pp

Package 2

*Coffee and Bacon Roll
on arrival*

18 Holes

*3 course lunch
from £40.00pp*

Package 3

*Coffee and Bacon Roll
on arrival*

18 Holes (Afternoon)

*3 course dinner
from £46.00pp*

Package 4

*Coffee and Bacon Roll
on arrival*

18 Holes

Soup & Ploughman's Lunch

18 Holes

*3 Course Dinner
from £66.00pp*

Contact Details

SBGC, Warden Hill Road, Luton, LU2 7AE.

E-Mail: office@southbedsgolfclub.co.uk

Fax: 01582 495381

Secretary 01582 591500

Steward 01582 581919

Professional 01582 591209

Restaurant 01582 596486